

Ecolodge Build Update April 2018

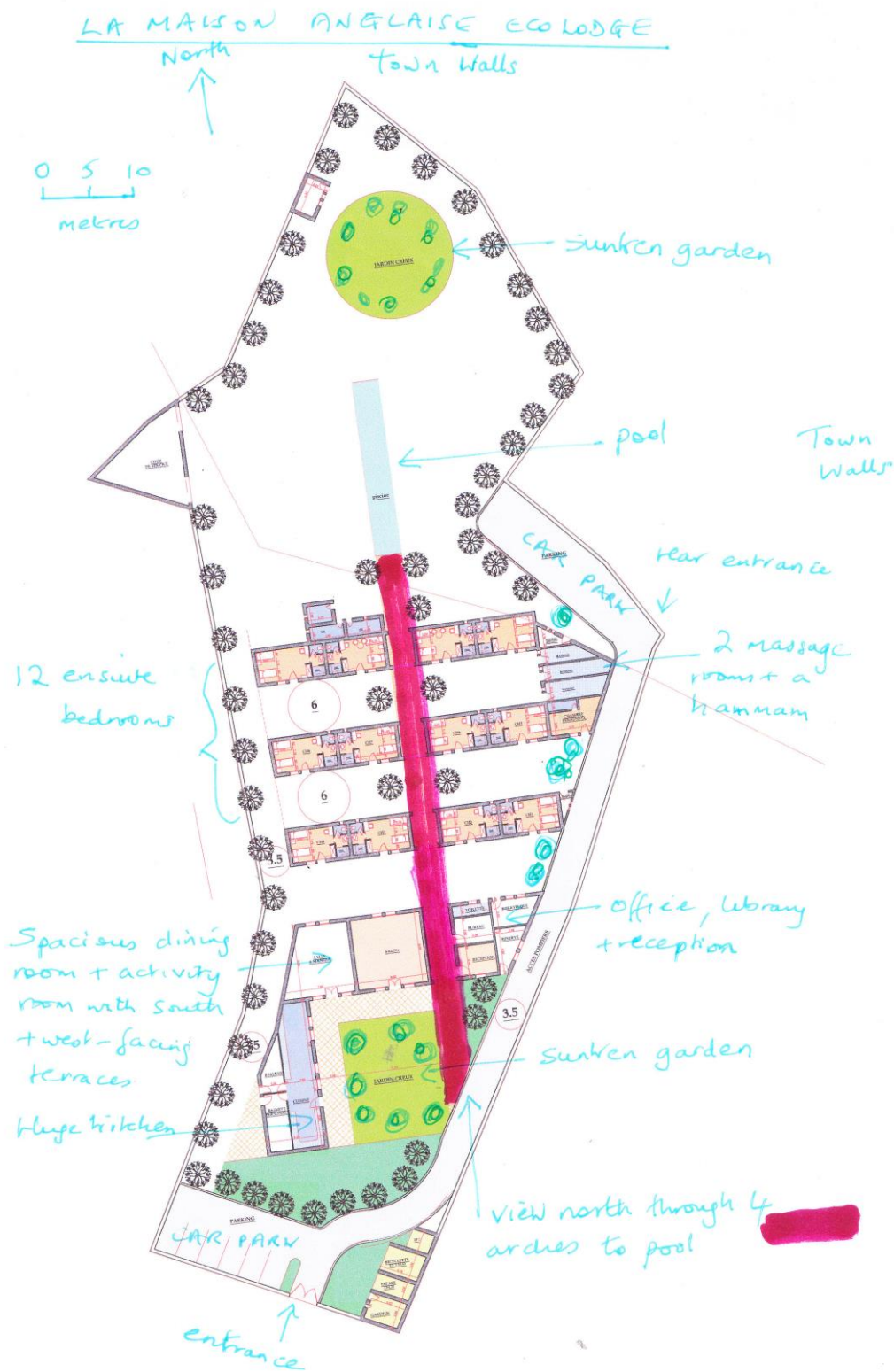

We have recently completed another period of research and have come to decisions on a variety of matters relating to:

Water and Energy Conservation and Health. Following the recent news that one of the reservoirs in the Casablanca region has shown the starkest decline (60%) of any in the world in the last 5 years., it is reason to redouble our efforts in conserving water. Our pool will now have a much smaller volume and surface area though it will retain the same long narrow swimming area (3 metres x 20 metres). We will be using a tried-and-tested system that works particularly well in hotter climates, provides a healthy environment for swimmers, water that is fit to be used for irrigation when the pool is emptied. This system uses very small quantities of silver and copper to disinfect the pool.

We will buy a **washing machine which uses ozone to disinfect the laundry**: this uses substantially less water and electricity because it works with cold water, with the added bonus is that the waste water is not polluted by washing powders and can be processed by our gravel bed with the rest of the grey water from the site.

The Gardens and Swimming Pool

We have re-positioned the swimming pool in a large garden area near the town walls, which result in attractive reflections of the trees around our boundary, the town walls and the towers. The red stripe on the plan shows how **the eye will be drawn through a series of 4 “keyhole” Taroudant style arches to the long pool which in turn leads to the beautiful circular sunken garden near the town walls.** This garden will be 15 metres in diameter with a central fountain; it will be a wonderful alternative site for activities.

As you enter from the gardens at the opposite (southern) end of the plot, **the eye will also be drawn to the highest peak of this part of the Western High Atlas Mountains (Jbel Aoulime at 3555 metres,** often snow-capped in the winter months) directly behind the town walls.

In addition, in this area we have created a huge circular sunken garden (about 15 metres diameter) with a central fountain which will be a wonderful alternative site for activities

The Kitchens and Dining Area

We will have **2 large terraces outside the dining room, one south facing (with shading in part) and a second a “dinner dining” area, west-facing, to catch the evening sun.** There will also be a large sunken garden with a fountain adjacent, particularly attractive at hotter times of day or in the summer. The kitchen will be huge with a section set aside for **cookery demonstrations.**

The Bedrooms

We small now have **some smaller bedrooms** which may either be used as single or double rooms. We made these changes in order to accommodate trees along the edge of the plot, which will be a bonus but the added benefit is that we will be able to offer some rooms at a lower price, which is important to us as because we'd like to ensure that our **new facilities are affordable** for all our clients.

Parking of vehicles

We small have areas for the parking of bicycles and motorised vehicles by both entrances, one onto the minor road by the town wall and the other onto the more major road.

Your Ideas

We continue to welcome ideas from our guests. Please email them to jane@holidays-with-heart.co.uk

In case you'd like to open and/or print a copy of our plan, here is a pdf version

Master Plan 16.4.18 Newsletter FINAL

To see earlier news on the project please see [this page](#)